

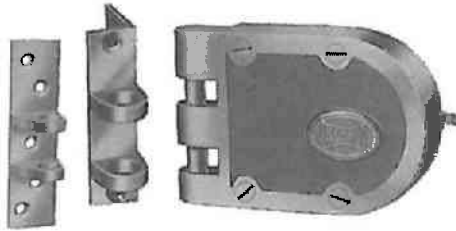

- VERTICAL DEADBOLT LOCKS
- HORIZONTAL DEADBOLTS

VERTICAL DEADBOLT LOCKS

Unique dropbolt rim locks which mount on the door, rather than within it.



JIMMY-PROOF VERTICAL DEADLOCK 600 SERIES

Features a cast-bronze case, double bolt, and a strike for strength. The case is 2-3/4" x 4-3/8" x 1". 7050 key cylinder.

Choose either outside cylinder with inside thumb knob, or keyhole both inside and outside for glass doors. Segal's exclusive shutter guard prevents the lock from being opened with a screwdriver, even if the cylinder is wrenched out.

Code	Cylinder	Strike	Price/Ea
SZ0666A0	Thumbknob and Key	Angled	95.00
SZ0667F0	Thumbknob and Key	Flat	95.00
SZ0688A0	Double	Angled	118.00
SZ0687F0	Double	Flat	117.00

PRESSURE-CAST RIM CYLINDER

Segal's lowest priced cylinder. This 5-pin pressure-cast brass plated cylinder will fit any rim lock. For doors 1-1/4" to 3" thick



SZ6050
15⁵⁰ ea

ANGLED STRIKE PLATE 600 SERIES

Replacement strike plate - 666 jimmy proof deadlock. Solid Bronze.

SZA-STRIKE
17⁰⁰ ea

FLAT STRIKE PLATE 600 SERIES

Replacement strike plate - 667 jimmy proof deadlock. Solid Bronze.

SZF-STRIKE
16⁰⁰ ea



667

666

FIVE-PIN RIM CYLINDER

For doors 1-1/4" to 3" thick. Made of solid bronze for strength and corrosion resistance. The keyway is #9 unless otherwise specified. Reversible bar available.



SZ7050
22⁵⁰ ea

CASE-RAISING BRACKETS

Designed to raise the lock flush with the jamb, these brackets are meant to be used for double-bolt vertical deadlocks and slamlocks.

SZ1325 Offsets: 1/4", 3/8" - 6 per box
23⁵⁰ ea

SZ1326 Offsets: 1/2", 5/8" - 3 per box
27⁰⁰ ea



CYLINDER GUARD PLATE

Solid-steel plate bolts on outside of door over any rim cylinder for maximum protection against drilling, cutting, or wrenching.



SZ007
7⁰⁰ ea

KEY BLANKS

Brass, 5 pin key blank for Segal locks. 50/box

SZK9
87¢ ea

